

CATALOGUE 2020

DOMETIC CARE

DOMETIC REFRIGERATORS AND SAFES
FOR HEALTH AND CARE FACILITIES

 **DOMETIC**



MEDICAL & FOOD

For safe storage of temperature sensitive medicines and patient food in retirement homes and hospitals.

PAGE 8 – 17



SAFETY & SECURITY

Dometic ProSafe – Advanced technology for safe and secure storage of valuables

PAGE 18 – 25



INTRODUCTION

ABOUT DOMETIC

4 – 5

MEDICAL & FOOD

DOMETIC MEDICAL REFRIGERATORS

8 – 13

Dometic DS absorption refrigerators

9

Dometic HC compressor refrigerators

10 – 11

Dometic MC 302 breast milk refrigerator

12 – 13

DOMETIC FOOD REFRIGERATORS

14 – 15

Dometic Silencio Food Line
absorption refrigerators

14 – 15

Ventilation instructions

16

Dometic CoolFreeze CFX compressor coolers

17

SAFETY & SECURITY

DOMETIC PROSAFE ROOM SAFES

18 – 19

Dometic ProSafe Premium Class room safes

20 – 23

Dometic ProSafe Standard Class room safes

24 – 29

DOMETIC ON THE WEB

Here's where you can find the complete Dometic range, with detailed information about all products. Plus, interesting facts about our company and download links for all our catalogues.

www.dometic.com/care

WELL PROVEN FOR DECADES

DOMETIC REFRIGERATORS AND SAFES FOR HEALTH AND CARE FACILITIES

Dometic is a leading manufacturer of cooling appliances for special applications – with decades of experience in the healthcare sector. Our reference list includes hospitals, retirement and nursing homes, doctor's surgeries, pharmacies and laboratories.

Dometic Medical and Food Line refrigerators have been proven thousands of times over, across Europe and beyond. They are among the most compact of their kind available in the market. With its ProSafe range, Dometic also provides a reliable solution for secure storage of the patients' or residents' valuables.

All products for the healthcare sector are manufactured to stringent quality and environmental standards in Dometic's, certified factories. Our sales and service network spans almost 100 countries and provides personal support to customers and planners on all continents.

RESPONSIBILITY FOR THE ENVIRONMENT

At Dometic, thinking and acting ecologically is an all-embracing process that extends to all levels – from the design of resource-saving, energy-efficient products to sustainable production processes and special recycling measures. You can be 100% sure that all applicable regulations, directives and guidelines are fulfilled.

CERTIFIED QUALITY

- All Dometic production plants are certified according to ISO 9001 and ISO 14001 as well as the Eco-Management and Audit Scheme.
- Dometic is an EMAS-certified company. All environmental results are published in Dometic Environmental Product Declarations.
- All products fulfil the requirements of the European Union's ROHS directive.



Dometic's certified production facility at Jászberény, Hungary



DOMETIC PRODUCTS VALUE PROPOSAL

FOR HOSPITALS, RETIREMENT HOMES, SURGERIES AND PHARMACIES

HOSPITALS & CLINICS

Having their own Food Line fridge and ProSafe in the room gives patients peace of mind and comfort while away from home. They are less dependent on staff for drinks and food and can rest assured that their valuables are safely stored. This, in turn, relieves the staff and cuts on operating costs. Hotel-like amenities can also help hospitals and clinics stand out from their competitors. Medical refrigerators on the station floor provide easy access to daily medications and common prescriptions, which means shorter distances to go for the hospital staff.

Product examples: DS 400, HC 302 DIN, DS 301 H and MD 363

RETIREMENT HOMES

Dometic Food Line refrigerators take up very little space and offer a great deal of comfort. They make the residents feel more at home, and more independent too. This relieves the nursing staff and gives them more time for other tasks. Dometic medical refrigerators provide safe storage for temperature-sensitive pharmaceuticals and fast access to "daily essentials".

Product examples: DS 400, HC 302 DIN and MD 363

SURGERIES AND PHARMACIES

Dometic medical refrigerators keep temperature-sensitive pharmaceuticals, preparations and vaccines close at hand for immediate access. They provide safe storage at a temperature between +2°C and +8°C. The well organised, illuminated interior with practical drawers and compartments makes for easy handling.

Product examples: HC 302 DIN, HC 502 DIN and DS 601 H





& FOOD





DOMETIC MEDICAL REFRIGERATORS

THE MOST COMPACT MODELS

The ideal solution for storing heat-sensitive medicine safely at a temperature between +2 °C and +8 °C. Practical drawers enable you to keep the medicine organised and structured. A digital thermometer monitors the internal temperature and stores the highest and lowest temperature for a defined control period.

You can choose between two series with different cooling technologies and quality features:

HC series with powerful, energy saving compressor technology: with integrated temperature display and high-quality, roller based metal drawers (3/4 extension) with plastic front

DS series with noiseless absorption cooling: for normal ambient temperatures, fitted with an external thermometer and plastic drawers (1/2 extension) with transparent front

QUALITY FEATURES

- Constant cooling performance between +2 °C and +8 °C
- DIN certified medical refrigerators
- High-quality metal drawer with telescopic sliders
- Digital temperature display with memory function
- Audible alarm functions
- Lock included

WHY CONVENTIONAL HOUSEHOLD REFRIGERATORS WON'T WORK

Conventional household refrigerators are unsuitable for the storage of insulin, vaccines, heparin products and other heat-sensitive pharmaceuticals. Here are the main reasons why:

- Unable to maintain the required temperature between +2 °C and +8 °C
- Temperature can rise to over +10 °C during defrosting phases
- Temperature data cannot be checked and documented
- Serious health risks for patients
- Liability risks for hospitals

A medical refrigerator keeps you on the safe side.

DS SERIES MEDICAL REFRIGERATORS

NOISELESS ABSORPTION COOLING

Well proven over the last decades, DS series medical refrigerators are ideal for safe storage of insulin and other heat-sensitive pharmaceuticals at a temperature between 2°C and 8°C. The drawers allow for an organised storage of pharmaceuticals. The external digital thermometer keeps the interior temperature under control.

- Noiseless absorption cooling unit
- Fuzzy Logic technology for low power consumption
- Adjustable temperature settings for efficient usability
- LED interior light for user convenience
- Door lock for secure storage
- Drawers with flexible compartments for organized storage



Interior light



TECHNICAL DATA

MODEL	DS 301 H	DS 601 H
Storage volume (litres)	26	49
Cabinet colour	White	White
Cooling technology	Absorption	Absorption
Temperature (fixed)	5°C	5°C
Dimensions (H×W×D, mm)	580×422×393	592×486×494
Energy consumption (kWh/24 h)	0.86	1.05
Drawers (number)	3	3
Door lock	•	•
Digital thermometer with data memory	external	external
Variable door hinge	•	•

HC SERIES DIN MEDICAL REFRIGERATORS

EXCELLENT STORAGE CONDITIONS FOR HIGHEST DEMANDS

Medical refrigerators have to meet the very highest demands, and they have to be absolutely reliable. To be on the safe side, use equipment that complies with the DIN 58345 standard for pharmaceutical refrigerators, because it will meet the expectations for professional storage to the full extent. In addition to standard features like temperature setting, ventilated cooling and a safety

lock, our DIN certified equipment also provide a visual and audible warning function in case of temperature deviations. Thanks to an integrated battery the warning function (visual + audible) will even be maintained for at least 12 hours if the power supply fails. On top of that, DIN refrigerators are fitted with a potential free contact for alarm transmission.



Complies with DIN 58345 and Ö-Norm K2040



TECHNICAL DATA

MODEL	HC 302 DIN	HC 502 DIN
Cabinet colour	White	White
Cooling technology	Compressor	Compressor
Temperature (fixed)	5°C	5°C
Dimensions (H×W×D, mm)	580×422×450	592×486×494
Energy consumption (kWh/24 h)	0.42	0.44
Drawers (number)	3	3
Door lock	●	●
Digital thermometer with data memory	integrated	integrated
Variable door hinge	●/-	●/-

- Complies with DIN 58345 and Ö-Norm K2040
- Keeps heat sensitive medicine between +2°C and +8°C
- Integrated fan for reliably constant temperature
- Features an audible warning system if the door is open for more than 20 s
- Compressor cooling technology
- Convenient, robust slide-out drawers

ADDITIONAL DIN FEATURES

- Temperature variation alarm
- Power failure alarm
- External, potential free contact for alarm transmission
- AC powered display (no batteries)



Integrated in the door: illuminated thermometer min/max data memory to monitor the interior temperature



Drawers with transparent front panel



Ergonomic door handle



Interior light



Lockable door

HC SERIES MEDICAL REFRIGERATORS

NON DIN VERSIONS

Based on efficient compressor cooling, HC series medical refrigerators are amazingly powerful and energy-saving. Moreover, the models in the HC series are fitted with some useful extra features. High-quality, roller based metal drawers with 3/4 extension allow for convenient handling in everyday use, and the thermometer is integrated in the door.

- High-performance compressor cooling – even at high ambient temperatures
- Integrated in the door: illuminated thermometer min/max data memory to monitor the interior temperature
- High-quality, roller based metal drawers with 3/4 extension for well organised storage
- Door open alarm

Highly Efficient Compressor Cooling



TECHNICAL DATA

MODEL	HC 302	HC 502
Cabinet colour	White	White
Cooling technology	Compressor	Compressor
Temperature (fixed)	5°C	5°C
Dimensions (H×W×D, mm)	580×422×450	592×486×494
Energy consumption (kWh/24 h)	0.42	0.44
Drawers (number)	3	3
Door lock	•	•
Digital thermometer with data memory	integrated	integrated
Variable door hinge	•/-	•/-



Integrated thermometer



Drawers with transparent front panel



Ergonomic door handle



Interior light



Lockable door



WITH FACTORY PRESET FIXED TEMPERATURE

BREAST MILK REFRIGERATOR

Sensitive breast milk has to be stored at a temperature between +2 °C and + 4 °C to preserve its nutritional value and prevent health risks to the babies. The new MC 302 breast milk cooler provides the optimal storage conditions. A special control system ensures that the factory preset temperature of +2.5 °C is reliably maintained. The current temperature is shown on an external display – no need to open the door to check it. Additionally, any deviation from the admissible temperature range (+1 °C to +4 °C) is signalled by a warning signal.

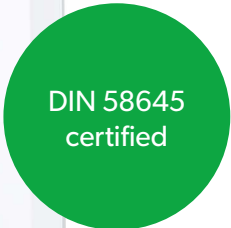



DOMETIC MC 302

Breast milk refrigerator, right hinged, 22 l

- DIN 58345 compliant
- Keeps heat-sensitive breast milk between +1 °C and +4 °C (factory preset fixed temperature of +2.5 °C)
- Door integrated with multi-functional temperature display.
- Integrated fan for reliably constant temperature
- Features an audible warning system if the door is open for more than 20 s
- Compressor cooling technology
- Convenient, robust slide-out drawers



TECHNICAL DATA

MODEL

MC 302

Storage volume (litres)

29

Cabinet colour

White

Cooling technology

Compressor

Temperature (fixed)

+2.5 °C

Dimensions (H × W × D, mm)

580 × 422 × 450

Energy consumption (kWh/24 h)

0.42

Drawers (number)

3

Door lock

•

Digital thermometer with data memory

integrated

Variable door hinge

• / -



Integrated in the door: illuminated thermometer min/max data memory to monitor the interior temperature



Drawers with transparent front panel



Ergonomic door handle



Interior light



Lockable door



COMPACT AND SILENT REFRIGERATION FOR FOOD AND MORE

SILENCIO FOOD LINE

Ideal for
Patient In Room
Comfort

Chilled drinks and food right at your fingertips at all times. When there is no room for an household refrigerator, a miniCool in the Food Line series has great benefits. Whether it's for everyday use in hospitals and nursing homes with the shortest possible distances for patients and residents or for a bit of privacy in student accommodation. The Food Line provides totally silent refrigeration without compromising on cooling performance. As the only cooling appliance in this class, the models are suitable for fresh food.

THE DOMETIC FOOD LINE MINI FRIDGE

Unique worldwide. No other noiseless refrigerator reaches an interior temperature of 4°C at up to an ambient temperature of 32°C.

IDEAL FOR:

- Nursing homes
- Hospitals
- Offices/meeting rooms
- At home as an additional refrigerator in the bedroom, living room or children's room
- Student homes/apartments



White

Built-in

Black



MODEL	DS 200 FS/BI	DS 300 FS/BI	DS 400 FS/BI	DS 600 FS/BI
Model class (litre)	20	30	40	60
Storage volume (litre)	21	27	32	43
Cabinet colour	Black or white	Black or white	Black or white	Black or white
Dimensions FS* (H x W x D, in mm)	495 x 422 x 393	580 x 422 x 393	580 x 422 x 450	592 x 486 x 494
Dimensions Built-in version** (H x W x D, in mm)	455 x 422 x 383	540 x 422 x 383	540 x 422 x 440	552 x 486 x 484
Can be built-in/integrated	●	●	●	●
Variable door hinge	●	●	●	●
LED interior light	●	●	●	●
Input rating (W)	65	65	65	65
Energy consumption (kWh/24 h)	0.74	0.76	0.76	0.77
Noise level (db[A])	0	0	0	0
Features	<ul style="list-style-type: none"> Adjustable plastic shelf with recess for tall bottles Flat inner door 	<ul style="list-style-type: none"> 2 adjustable plastic shelves with recess for tall bottles Flat inner door 	<ul style="list-style-type: none"> 2 adjustable plastic shelves 3 adjustable door racks 	<ul style="list-style-type: none"> 2 adjustable plastic shelves 3 adjustable door racks
Options	<ul style="list-style-type: none"> Sliding hinge Lock Wheels 	<ul style="list-style-type: none"> Sliding hinge Lock Wheels 	<ul style="list-style-type: none"> Sliding hinge Lock Wheels 	<ul style="list-style-type: none"> Sliding hinge Lock Wheels

*FS version: with foot frame, door decor panel and back cover, ** BI version: for fully-integrated installation (with sliding hinge, without exterior ABS plastic cabinet, door panel and foot frame) Please note our ventilation tips for built-in refrigerators (p. 16).



DS 200 FS/BI



DS 300 FS/BI



DS 400 FS/BI



DS 600 FS/BI



EASY CUSTOMIZING WITH BI MODELS

Designed for built-in use: BI mini fridges are fitted in the factory with a sliding hinge to be fastened to the furniture door to compensate for the differing turning points between the furniture and fridge door. That means the refrigerators can be easily fitted with a front panel to suit your interior design concept.

INSTALLATION TIPS FOR BUILT-IN REFRIGERATORS



THINGS TO NOTE WHEN INSTALLING A BUILT-IN ABSORPTION REFRIGERATOR

- The refrigerator must be placed on a surface that is level in both directions
- There should be 2 cm clearance to the wall
- Ventilation must be provided as shown in the drawings below (A, B, C or D)
- The ventilation duct must at least measure 105 mm x the width of the refrigerator
- The entire cooling unit should protrude into the ventilation duct as shown
- Air passing through the duct must not be warmed up by any source of heat
- Ventilation grills, if used, must have a free opening of at least 200 cm² each

Dometic absorption fridges are equipped with an electrically heated cooling unit which is virtually silent in operation. The heat which the cooling unit extracts from the refrigerator interior is emitted at the back of the fridge. If you have a free-standing model, sufficient ventilation is provided in most cases. If you want to integrate the fridge into a piece of furniture, however, the following instructions need to met.

Please note that there must be sufficient room for ventilation behind the refrigerator to prevent heat build-up. As a rule of thumb, the free ventilation space should be at least 300 cm² for incoming air and at least 200 cm² for outgoing air. The distance from the rear of the refrigerator to the rear wall of the furniture must be at least 2 cm. During installation, make sure that the refrigerator is standing on a stable, level surface, and not directly near a heat source.

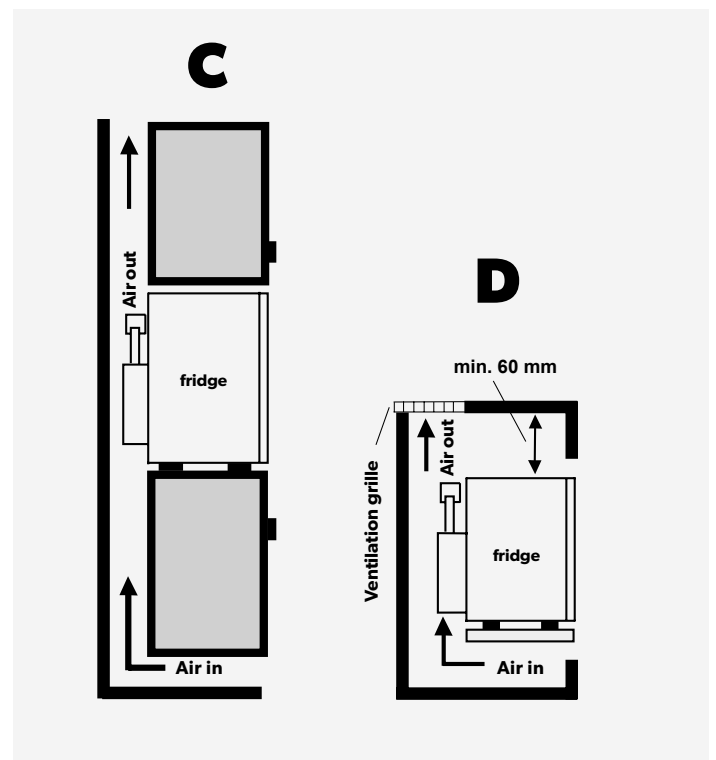
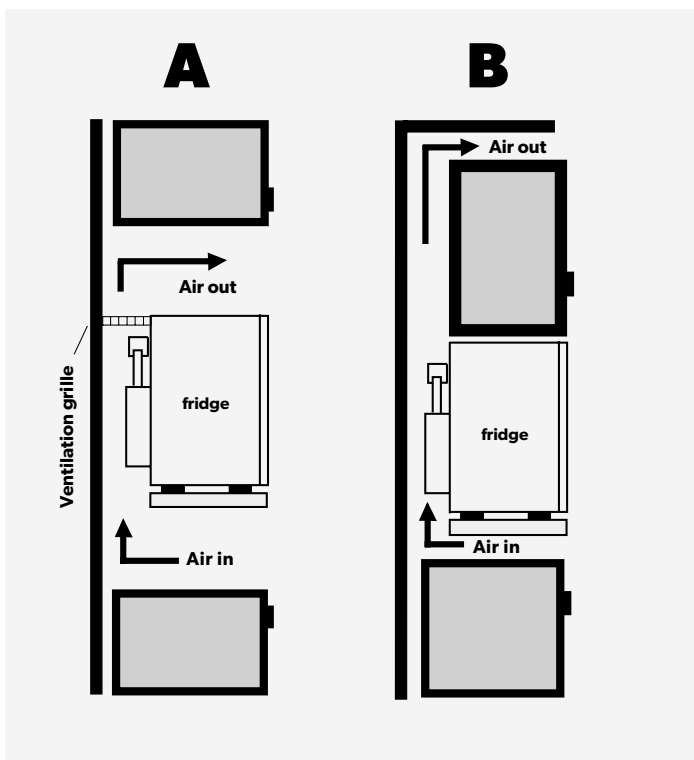

COOLFREEZE CFX COMPRESSOR COOLERS

RELIABLE COOLING AND DEEP-FREEZING DOWN TO -22 °C

Excellent cooling and freezing performance, low energy consumption – features you can depend on with each compressor appliance from Dometic. CoolFreeze CFX series coolers are perfectly equipped for safe transport of sensitive food in hospitals and nursing homes. Featuring a specially developed, high-performance compressor and an extra-strong insulation, they consume up to 35% less energy than comparable units.

Fitted with heavy-duty features like reinforced corners, stainless steel hinges and a robust lid lining, the high-tech coolers in the CFX series can withstand the most demanding of loads. Even so, they are remarkably lightweight and easy to transport. All models in the CFX professional series give you the convenient option of controlling and monitoring the cooling temperature by WiFi app.

TEMPERATURE CONTROL VIA WIFI APP

All CoolFreeze CFX coolers can be conveniently controlled by smart-phone. Our WiFi app provides plenty of options. You can set different cooling temperatures, battery protection levels and temperature alarms. Or switch the cooler on and off from a distance.

- ON/OFF switch
- Temperature setting via slider or button
- Programming of battery protection levels and temperature alarms
- Display of current temperature, energy source, voltage and warning messages
- Android and iOS version available

- Suitable for deep freezing down to -22 °C
- Excellent cooling performance even at extremely high outside temperatures
- 12/24 volts DC and 100 – 240 volts AC
- CFX special electronics with digital temperature display
- Extremely efficient and superbly quiet operation
- USB port for charging low-power electronic devices
- Drain plugs make cleaning simple
- Suitable for solar operation
- Heavy-duty design
- Temperature control by WiFi app



CONTROLLED
VIA WIFI APP



12/24 V



100-240 V



SOLAR
OPERATION



ENERGY CLASS

For the complete CFX range please visit dometic.com



LED light – energy-efficient LED interior light



Connectivity USB port for charging small electronic devices



Quick overview – electronic thermostat with digital temperature display



Temperature control via WiFi app



SAFETY &



SECURITY



FROM STANDARD TO PREMIUM

THE RANGE OF DOMETIC PROSAFE MODELS

Security is an essential requirement for hotel guests, and one of the main reasons for choosing or discarding a destination and a hotel. The Dometic GROUP, aware of this, is always developing and improving all of its products in order to meet the needs of customers.

The latest product innovation Dometic has launched is a proSafe range which goes one step further in terms of design, functionality, technology and security. This proSafe range has a very modern design with a color display, an illuminated keypad, the latest anti-tampering system and a new website platform which offers the possibility to

operate the safe with the strictest security. The elegant cabinets of the new proSafe generation have rounded corners and edges for enhanced safety. Contemporary design

- Master key
- LED interior light
- iAudit system – unique in the industry
- Remote Emergency Opening System (REOS 2.0)
– ultimate security and user comfort
- Battery level check



PREMIUM CLASS

Excellence in form and function: Dometic innovations like iAudit tracking and the REOS Remote Emergency Opening System ensure security on all levels.

STANDARD CLASS

High security level combined with easy operation for perfect comfort and convenience.

PRODUCT FINDER – THE QUICK WAY TO FIND THE RIGHT PRODUCT

LASER-CUT DOOR

Our doors are precisely cut and crafted by a laser beam. This allows us to achieve 100% accuracy in dimensions and an extremely small clearance between the door and casing, making the door impossible to pry open.

ANTI-TAMPER SYSTEM

With the anti-tampering system, Dometic offers a unique security feature for their models. All anti-tampering manipulation attempts are recorded in the electronic of the safe and can be tracked back at any time.

REOS CODE

REOS stands for Dometic’s Remote Emergency Opening System. The emergency-opening system from Dometic is based on an innovative encoding system. The unique solution combines advanced electronics with state-of-the-art online technology to allow simple yet highly secure emergency opening by authorised hotel staff.

PREMIUM iAUDIT

All operations effected on a safe must be documented – for your own security and for your insurance provider. This is where

Dometic’s Premium iAudit system offers a truly convenient solution: the integrated microchip provides storage capacity for the last 1,000 events.

SAM

The unique Dometic safe managementsystem (SAM) allows for iAudit Trail and one time emergency code generation (REOS) from a user friendly but PIN secured internet based software tool.

● Yes / – No / ○ Optional

WHAT’S IMPORTANT TO YOU?	PREMIUM CLASS	STANDARD CLASS
Easy operation	●	●
Motorised opening	●	●
LED interior light	●	●
LED display	●	●
Emergency opening with master key	●	●
Emergency opening with master code	●	●
Emergency opening with REOS Code	○	–
Anti-Tamper System	○	–
Premium iAudit	●	–
SAM	○	–
Laser-cut door	●	–
From page	32	36



SAFE TO SAY IT'S MORE CONVENIENT

PREMIUM CLASS IN-ROOM SAFES

DOMETIC PREMIUM CLASS SAFES

Protection for more privacy – comfortably and with absolute reliability. With a Premium Class proSafe, a hotel room becomes a perfectly private haven for the guest. A safe place for storage, conceived and implemented according to the newest standards. Its innovative and customisable design suits every hotel in a stylish way. Smooth surfaces and rounded edges make it easy to look after and give it long-lasting character. A color display and the integrated soft-touch keypad make operation easy. And a Premium Class proSafe also

breaks new ground when it comes to protective properties: pioneering technology like the unique iAudit and the anti-tampering system ensure security on all levels. The demand for contemporary security systems with added convenience is supported by special features such as REOS 2.0 software with its emergency code-opening system (optional).

- LED interior light
- Laser-cut door and frame
- iAudit for convenient documentation
- Emergency opening with key and master code
- Remote Emergency Opening System (REOS 2.0) – ultimate security and user comfort (optional)



WIDE CHOICE OF MODELS AND SIZES

Dometic ProSafe MD series Premium Class safes are available in various sizes to suit different capacity demands, interior designs and installation conditions. Sizes range from 8.2 to 29 litres.



Batteries included – Dometic safes come ready to use.



Optional inside plug to charge mobile devices.



Automatic opening – Safe door opens automatically.



Fixing kit – Optional fixing kit for secure fastening.

SAFETY & SECURITY

SAFETY SOLUTIONS / PROSAFE PREMIUM CLASS

**PROSAFE PREMIUM
TECHNICAL DATA**



MODEL	MD 283	MD 363	MD 383
Type of product	Electronic safe		
Capacity (liters)	8.2	24	28
Exterior dimensions (H×W×D, mm)	165×280×235	190×360×410	190×380×450
Interior dimensions (H×W×D, mm)	162×277×185	187×357×360	187×377×400
Steel thickness (mm)	Door: 5.0 / Body 1.2	Door: 5.0 / Body 1.5	Door: 5.0 / Body 1.5
Net weight (kg)	6.1	10.2	11.3
Keypad	ADA-compliant rubber keypad		
Display	White LED color display, 4-digit guest code, English language		
Locking mechanism	Two 18 mm solid steel bolts		
Locking system	Motorised with automatic opening		
Power	4 LR6/AA 1.5 V batteries (incl.)		
Cabinet color	Anthracite		
FEATURES			
LED interior light	●	●	●
Laser cut technology	●	●	●
Masterkey opening	●	●	●
Mastercode opening	●	●	●
Anti-tampering System	○	○	○
REOS	○	○	○
iAudit	●	●	●
Laptop size	-	15"	17"
OPTIONS			
	<ul style="list-style-type: none"> • Left-hand hinge • Fixing Kit 	<ul style="list-style-type: none"> • Left-hand hinge • White color • Two steps emergency code opening (REOS) • Integrated socket (EU/US/UK/FR) • Fixing Kit 	<ul style="list-style-type: none"> • Left-hand hinge • White color • Two steps emergency code opening (REOS) • Integrated socket (EU/US/UK/FR) • Fixing Kit



PROSAFE PREMIUM TECHNICAL DATA		
MODEL	MD 408	MD 493
Type of product	Electronic safe	
Capacity (liters)	22.5	29
Exterior dimensions (H × W × D, mm)	190 × 405 × 350	190 × 490 × 370
Interior dimensions (H × W × D, mm)	187 × 402 × 300	187 × 487 × 320
Steel thickness (mm)	Door: 5.0 / Body 1.5	Door: 5.0 / Body 1.5
Net weight (kg)	10.4	12.4
Keypad	ADA-compliant rubber keypad	
Display	White LED color display, 4-digit guest code, English language	
Locking mechanism	Two 18 mm solid steel bolts	
Locking system	Motorised with automatic opening	
Power	4 LR6/AA 1.5 V batteries (incl.)	
Cabinet color	Anthracite	
FEATURES		
LED interior light	●	●
Laser cut technology	●	●
Masterkey opening	●	●
Mastercode opening	●	●
ANTI-TAMPERING SYSTEM	○	○
REOS	○	○
iAudit	●	●
Laptop size	15"	17"
OPTIONS		
	<ul style="list-style-type: none"> • Left-hand hinge • White color • Two steps emergency code opening (REOS) • Integrated socket (EU/US/UK/FR) • Fixing Kit 	<ul style="list-style-type: none"> • Left-hand hinge • Fixing Kit

● Yes / – No / ○ Optional

DOMETIC STANDARD CLASS SAFES

ROBUSTLY MADE WITH USER-FRIENDLY FEATURES AND FUNCTIONS

It puts hotel guests' mind at rest to have a safe place for their valuables while travelling. Providing a secure space for important or valuable objects yet it is a distinctive feature when choosing a hotel room or suite. With a Standard Class ProSafe, you can create a reliable spot in a guest room that is worth every penny. Security and functionality are paramount with all Dometic safe models. The Standard Class safe models offer your guests a high level of security thanks to their robust construction. Their simple and intuitive usability provides perfect comfort and convenience.

- Robust and reliable
- LED display
- LED interior light
- Master key and master code emergency opening
- Wide choice: vertical, horizontal, top-opening

DOMETIC PROSAFE MDL – VERTICAL OR HORIZONTAL

MDL 408



MDL 193



With quality and security at their core, these value-for-money in-room safes significantly enhance the security of existing hotel rooms.

- Value-for-money solution for upgrading hotel rooms
- Vertical or horizontal model – both with 18.4 liters capacity
- Easy installation inside a cabinet or on the wall
- Emergency opening with master code or master key
- Battery-low warning alerts users to change battery

DOMETIC PROSAFE MD 310 / 390 / 450 SAFE INVESTMENT

The doors on all the Standard Class safe models are precisely cut and crafted. Their robust construction and a locking system with extra-strong steel bolts leave no point of attack for burglars. The LED interior light minimises the risk of forgotten valuables. Fast and secure emergency opening is possible with a master key or master code (depending on the model).

- Robust, reliable construction for optimal safety
- LED interior light makes the contents visible at a glance
- Emergency opening with master key or master code



DOMETIC PROSAFE MDT TOP-OPENING SAFE

Part of the Dometic Standard Class range, the Dometic ProSafe MDT 400 X top-opening safe provides a simple, yet ingenious solution that is easy to operate and safe to use. The top-opening drawer safe can be integrated in an existing furniture drawer and provides easy access to guests' valuables. At the same time it meets the highest demands on ergonomic design, comfort and security with an LED inside light for standard, master key and master code opening possibility in case of emergency, digital LED illuminated keypad, four-digit code and top-opening stabilizer arm. An audio signal confirms that the safe is securely locked.

- Convenient access from above
- LED interior light makes the contents visible at a glance
- Enough room to fit laptop and tablet computers
- Ideal for installation into existing hotel room drawer
- Stabilizer arm for smooth opening and closing of the lid



SAFETY & SECURITY

SAFETY SOLUTIONS / PROSAFE STANDARD CLASS

**PROSAFE STANDARD
TECHNICAL DATA**



MODEL	MD 310	MD 390	MD 450
Type of product	Electronic safe		
Capacity (liters)	9	31.5	30.4
Exterior dimensions (H × W × D, mm)	165 × 310 × 245	200 × 390 × 480	200 × 450 × 410
Interior dimensions (H × W × D, mm)	161 × 306 × 182	196 × 386 × 418	196 × 446 × 348
Steel thickness (mm)	Door: 5.0 / Body 2	Door: 5.0 / Body 2	Door: 5.0 / Body 2
Net weight (kg)	7.1	14.3	14.5
Keypad	Rubber keypad		
Display	Red LED 4-digit guest code, English language		
Locking mechanism	Two 19 mm steel bolts		
Locking system	Motorised with automatic opening		
Power	4 LR6/AA 1.5 V batteries (incl.)		
Cabinet color	Anthracite		
FEATURES			
Confirmation buzzer	●	●	●
LED interior light	●	●	●
Door handle opening	-	-	-
Masterkey opening	●	●	●
Mastercode opening	●	●	●
Anti-tampering System	-	-	-
REOS	-	-	-
iAudit	-	-	-
Laptop size	-	17"	15"

OPTIONS

(available for all models)

- Left-hand hinge
- Fixing kit



MDT 400X

MDL 408

MDL 193

		Electronic safe	
9.7	18.4	18.4	
130 x 400 x 350	190 x 405 x 300	405 x 190 x 300	
75 x 380 x 300	187 x 402 x 245	402 x 187 x 245	
Door: 3.0 / Body 1.5	Door: 4.0 / Body 1.5		
9	10		
Rubber keypad	Rubber keypad		
Red LED 4-digit guest code, English language	Red LED 4-digit guest code, English language		
Two 19 mm steel bolts	Two 18 mm solid steel bolts		
Motorised with automatic opening	Motorised		
4 LR6/AA 1.5 V batteries (incl.)	4 LR6/AA 1.5 V batteries (incl.)		
Anthracite	Anthracite		
●	–	–	
●	–	–	
–	●	●	
●	●	●	
●	●	●	
–	–	–	
–	○	○	
–	○	○	
15"	13"	13"	
• Fixing kit	<ul style="list-style-type: none"> • Left-hand hinge • Fixing kit • White cabinet color 	<ul style="list-style-type: none"> • Left-hand hinge • Fixing kit • White cabinet color 	

● Yes / – No / ○ Optional

FANCY MORE? REQUEST OUR CATALOGUES!

2020



THE LARGE EQUIPMENT RANGE FOR HOTELS

Silent absorption minibars, room safes and wine refrigerators – all designed to enhance guest satisfaction.

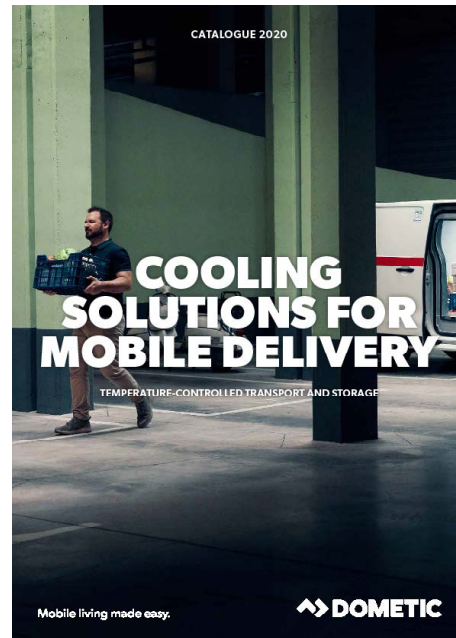

PROFESSIONAL COOLING FOR TEMPERATURE-CONTROLLED TRANSPORT

Portable coolers, stationary medical refrigerators, fitted equipment for ambulances and more. High-precision temperature management, up-to-date documentation, convenient handling.

OUR CATALOGUES ARE AVAILABLE ON OUR WEBSITE [DOMETIC.COM](https://www.dometic.com)

You can browse through the pages online, or download a PDF file. To request printed catalogues, please contact us by mail at:

info@dometic.com



Dometic is a global company that makes mobile living easy – by providing great solutions to satisfy people’s essential needs when they are on the move. Like cooking, taking care of personal hygiene and maintaining a pleasant temperature. We offer smart and reliable products with outstanding design.



BELGIUM

DOMETIC BRANCH OFFICE BELGIUM

Lourdesstraat 84 B
B-8940 Geluwe
Tel +32 2 3598040
Fax +32 2 3598050
Mail info@dometic.be

DENMARK

DOMETIC DENMARK A/S

Nordensvej 15, Taulov
DK-7000 Fredericia
Tel +45 75585966
Fax +45 75586307
Mail info@dometic.dk

EASTERN EUROPE

DOMETIC AB

Hemvärnsgatan 15
SE-171 54 Solna
Tel +46 (0)8 501 02 500
Mail lodging.export@dometic.com

FINLAND

DOMETIC FINLAND OY

Valimotie 15
FIN-00380 Helsinki
Tel +358 20 7413220
Fax +358 9 7593700

FRANCE

DOMETIC SAS

ZA du Pré de la Dame Jeanne
B.P. 5
F-60128 Plailly
Tel +33 3 44633525
Fax +33 3 44633518
Mail lodging@dometic.fr

GERMANY & AUSTRIA

DOMETIC GMBH

In der Steinwiese 16
D-57074 Siegen
Tel +49(0) 271 692 0
Fax +49 (0) 271 692 302
Mail info@dometic.de

HUNGARY

DOMETIC ZRT. SALES OFFICE

H-1147 Budapest
Kerekgyártó u. 5.
Tel +36 1 468 4400
Fax +36 1 468 4401
Mail budapest@dometic.hu

ITALY

DOMETIC ITALY S.R.L.

Via Virgilio, 3
I-47122 Forlì (FC)
Tel +39 0543 754901
Fax +39 0543 754983
Mail vendite@dometic.it

NETHERLANDS

DOMETIC BENELUX B.V.

Ecustraet 3
NL-4879 NP Etten-Leur
Tel +31 76 5029000
Fax +31 76 5029019
Mail info@dometic.nl

NORWAY

DOMETIC NORWAY AS

Østerøyveien 46
N-3236 Sandefjord
Tel +47 33428450
Fax +47 33428459
Mail firmapost@dometic.no

POLAND

DOMETIC POLAND SP. Z O.O

ul. Puławska 435A
PL-02-801 Warszawa
Tel +48 22 414 3200
Fax +48 22 414 3201
Mail info@dometic.pl

PORTUGAL

DOMETIC SPAIN, S.L.

Branch Office em Portugal
Rot. de São Gonçalo nº 1- Esc. 12
2775-399 Carcavelos
Tel +351 219 244 173
Fax +351 219 243 206
Mail info@dometic.pt

RUSSIA

DOMETIC RUS LLC

ul. Malaya Pirogovskaya 18-1
119435 Moscow
Tel +7 495 780 79 39
Fax +8 800 100 16 17
Mail info@dometic.ru

SPAIN

DOMETIC SPAIN S.L.

Avda. Sierra del Guadarrama, 16
E-28691 Villanueva de la Cañada
Madrid
Tel +34 91 833 6089
Fax +34 900 100 245
Mail info@dometic.es

SWEDEN

DOMETIC SCANDINAVIA AB

Gustaf Melins gata 7
S-421 31 Västra Frölunda
Tel +46 31 7341100
Fax +46 31 7341101
Mail info@dometic.se

SWITZERLAND

DOMETIC SWITZERLAND AG

Riedackerstrasse 7a
CH-8153 Rümlang
Tel +41 44 8187171
Fax +41 44 8187191
Mail info@dometic.ch

MIDDLE EAST & AFRICA

DOMETIC MIDDLE EAST FZCO

P.O. Box 17860
S-D 6, Jebel Ali Freezone
Dubai
Tel +971 4 883 3858
Fax +971 4 883 3868
Mail info@dometic.ae

UNITED KINGDOM

DOMETIC UK LTD.

Domestic House, The Brewery,
Blandford St. Mary
Dorset DT11 9LS
Tel +44 344 626 0133
Fax +44 344 626 0143
Mail sales@dometic.co.uk

EXPORT

Domestic Competence Center
In der Steinwiese 16
D - 57074 Siegen, Germany
Tel +49 (0) 271 692 121
Mail lodging.export@dometic.com

TURKEY

ENTA A. S.

Gümüşsuyu Mah. İnönü Cad.
Taksim / Beyoğlu / İstanbul
Tel +90 212 292 89 00
Mail info@entatur.com

GREECE

SAMARAS

Anaximandrou 73
54250 Thessaloniki
Tel +30 231 032 1091
Mail polief96@otenet.gr

RUSSIA

MIKO

Leningradskiy pr. 30/2
125040 Moscow
Tel +7 495 651 09 45
Mail officemoscow@miko-hotelservices.com